

# 659621 Sizzix® Bigz™ Die - French Bow by Brenda Walton™

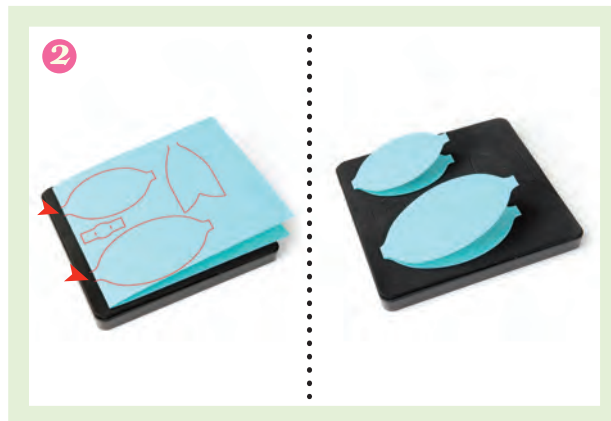

1. Die-cut from desired material



2. The die is designed to be used with a single fold technique for both of Bow pieces as well as the Ribbon piece. Align the folded edge of the paper with the open ends of the blade as shown. After running the die through the machine, you will have mirror images connected at the fold.



3. Create a soft bend on the bow by running it against the hard edge of a counter or a ruler. This is similar to curling ribbon with a pair of scissors. Adhere the end tabs to the center of the bow using quick-dry glue, and secure in place with paper clips.



4. Simple Bows can be created by using the small and large Bow pieces individually and are made by adhering the Bow pieces on top of the ribbon piece and finishing by wrapping the knot piece around the center.



5. Both small and large Bows are combined to create the finished French Bow. In this example, the knot piece has only been wrapped around the Bows, allowing the ribbon piece to be arranged independently.



6